

400 Amp Single Pin Inline and Panel Mount Connectors

CLS Series Single Pin Inline Connectors

are designed for maximum resistance to excessive torque loading. Constructed of weatherproof materials.

- NEMA 3R and NEMA 4R rated for wet locations
- UL Listed and CSA Certified
- Accepts up to 400A/600V

CL Series Single Pin Panel Mount Connectors

feature super tough nylon housings that won't chip or crack under extreme temperature and impact conditions.

- Stud Post or Set Screw style
- Self-threading screws
- Accepts up to 400A/600V
- Mounts with self-tapping stainless screws, eliminates lock washers and nuts

400A Inline Connectors

Size AWG	Male Part Number	Female Part Number
6-2	CLS2MB- X	CLS2FB- X
2-2/0	CLS20MB- X	CLS20FB- X
2/0-4/0	CLS40MB- X	CLS40FB- X



400A Panel Mount Connectors

Size AWG	Male Part Number	Female Part Number
Stud Post Style		
2/0-4/0	CL40MRB- X	CL40FRB- X
Set Screw Style		
2-2/0	CL20MRB- X	CL20FRB- X
2/0-4/0	CL40MRB- X	CL40FRB- X

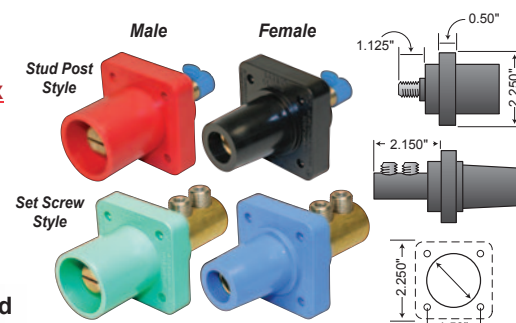

Protective Covers with Lanyard



Part Number
CL40FC-~~X~~
Fits Female Connector

Part Number
CL40MC-~~X~~
Fits Male Connector

Available colors:

- Black (A) ● Blue (D) ● Orange (G)
- White (B) ● Green (E) ● Yellow (H)
- Red (C) ● Brown (F)

TO ORDER, add desired color code (X) to the part number. Example: CLS2MB-C

Custom CLS Cables

We build **Arctic Ultraflex Blue®** pin connector cables to your exact specifications. Rigorous quality. Lifetime warranty. Call us today!



400 Amp Couplers and T Connectors



Hard 3-Line Tap
Male to 3 Females
Part Number
CA3F-~~X~~



Reverse Hard 3-Line Tap
Female to 3 Males
Part Number CA3M-~~X~~
(White (B) and green (E) only)



Soft 3-Line Tap
Male to 3 Females
Part Number
CA3FST-~~X~~



Paralleling T
Female to 2 Males
Part Number CPT-~~X~~



Tapping T
Male to 2 Females
Part Number CTT-~~X~~

Available colors:

- Black (A) ● Red (C) ● Green (E)
- White (B) ● Blue (D)

TO ORDER, add desired color code (X) to the part number. Example: CA3F-E

150 Amp Single Pin Inline and Panel Mount Connectors

CLM Series Inline Connectors have a Santoprene housing. Nylon retaining screw provides maximum fixation. Withstands heavy torque loading. Made of weatherproof materials.

- NEMA 3R and NEMA 4R rated for wet locations
- UL Listed and CSA Certified
- Accepts up to 150A/600V

CLM Series Panel Mount Connectors are supplied with self-threading screws.

- Stud Post or Set Screw style
- Santoprene housing
- Accepts up to 400A/600V

150A Inline Connectors 8 to 2 AWG

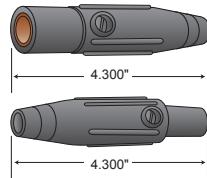

Male
Part Number
CLM2M-**X**

Female
Part Number
CLM2f-**X**

150A Panel Mount Connectors 8 to 2 AWG

Stud Post Style

Male
Part Number
CLMMRS-**X**

Female
Part Number
CLMFRS-**X**

Set Screw Style

Male
Part Number
CLMMR2-**X**

Female
Part Number
CLMFR2-**X**

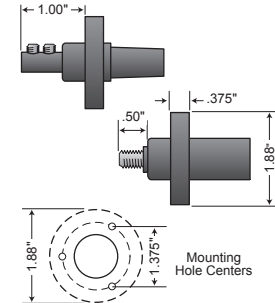

Protective Covers with Lanyard



Part Number
CLMMC-**X**
Fits male connector

Part Number
CLMFC-**X**
Fits female connector

Available colors:

- Black (A)
- Blue (D)
- Orange (G)
- White (B)
- Green (E)
- Yellow (H)
- Red (C)
- Brown (F)

TO ORDER, add desired color code (**X**) to the part number. Example: CLM2M-**B**

400 Amp to 150 Amp Cam Reducers

Cam Reducers and Reducer Connectors step down cable connections from large cam to small cam inline.

Cam Reducer

Part Number
CLMAD3F-**X**
Amperage Reduction
400A / 600V Male
to 3 150A / 600V
Females

Reducer Connectors

Part Number
CLMADFF-A
Amperage Reduction
400A Female to 150A Female
(available in Black only)

CLMADMF-**X**
400A Male to 150A Female

CLMADFM-**X**
400A Female to 150A Male

CLMADMM-**X**
400A Male to 150A Male



Available colors:

- Black (A)
- White (B)
- Red (C)
- Blue (D)
- Green (E)

TO ORDER, add desired color code (**X**) to the part number. Example: CLMAD3F-**D**

Custom CLM Cables

Our **Arctic Ultraflex Blue®** single pin connector cables are built to strict quality standards, right here in the USA. Made to order in any quantity. Lifetime warranty. Call to order!

